

QLF-2186-30

1.5~2.186GHz, 30dB

Features:

- * High Stopband Rejection
- * Small Size

Applications:

- * Telecom
- * Laboratory Test
- * Receivers
- * Instrumentation

Electrical

Passband:	1.5~2.186GHz
Passband Insertion Loss:	2.0dB max.
Passband Ripple:	2dB max.
VSWR:	1.6 max.
Stopband Attenuation:	10dBc@2.2775GHz min. 30dBc@2.37~3GHz min.

Mechanical

RF Connectors:	SMA Female Φ0.8mm Pin (optional)
Mounting:	4*M2, depth 4mm 4*M2 through-hole (optional)

Environmental

Operating Temperature:	-40~+70°C
Non-operating Temperature:	-55~+85°C

Outline Drawings

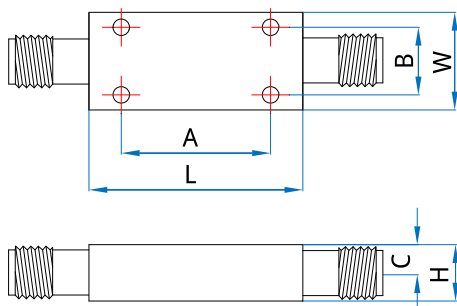

Size	L	W	H	A	B	C
mm	35	12	10	32	9	5
in	1.378	0.472	0.394	1.26	0.354	0.197

Outline A

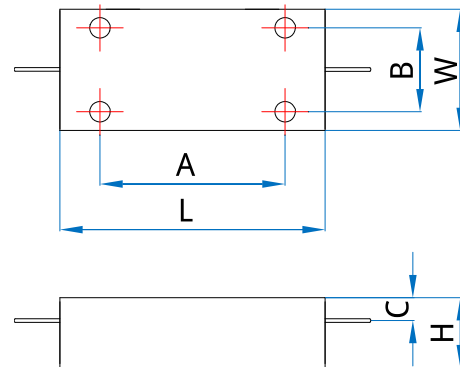

Size	L	W	H	A	B	C
mm	35	12	7	32	9	2.75
in	1.378	0.472	0.276	1.26	0.354	0.108

Outline B

Unit: mm [in]
Tolerance: ±0.2mm [±0.008in]

How To Order

- QLF-2186-30 - Outline A (SMA Female)
- QLF-2186-30-P - Outline B (Pin)

Customization is available upon request.